

REVIEWED/REVISED BY:
 MONTVILLE TWP ENGINEERING DEPARTMENT
 NICOLA MARUCCI, PE-PLS (LIC. #GB04257300)
 2018, 2020

REVIEWED/REVISED: 1986, 1987, 1988, 1989, 1990, 1991, 1992
 1993, 1995, 1997, 1998, 2000, 2003, 2004, 2010, 2011, 2014
 MARK J. MANTYLA
 PROFESSIONAL LAND SURVEYOR, #31,272
 MONTVILLE TOWNSHIP ENGINEERING DEPARTMENT
 MONTVILLE, N.J. 07045

THIS TAX MAP WAS DIGITIZED FROM A SCAN OF THE MYLAR DRAWING ORIGINAL DRAWING BY AERO SERVICE CORPORATION DATED 1959 AND SUBSEQUENTLY AMENDED AND ON FILE IN THE MONTVILLE TOWNSHIP ENGINEERING OFFICE.
 MARK J. MANTYLA
 PROFESSIONAL LAND SURVEYOR
 NJ LICENSE #GB031272

MODEL DETAIL
 TYPICAL FLOOR PLAN
 DETAIL (FIRST AND SECOND
 FLOOR PLANS ARE THE
 SAME) EACH UNIT IS ONE
 FLOOR WITH TWO UNITS
 PER FLOOR.

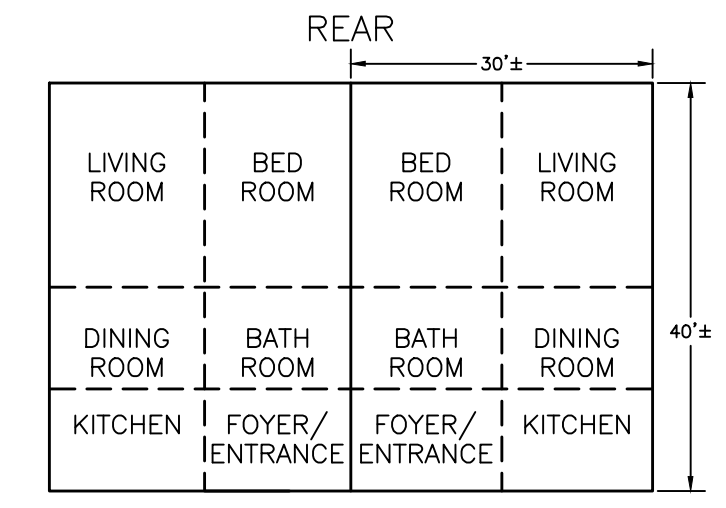

NEW JERSEY DEPARTMENT OF THE TREASURY
 DIVISION OF TAXATION
 LOCAL PROPERTY AND PUBLIC UTILITY BRANCH
 APPROVED AS A TAX MAP PURSUANT TO THE
 PROVISIONS OF CHAPTER 175, LAWS OF 1913, etc.
 FOR THE DIRECTOR, DIVISION OF TAXATION
 BY: *J. N. Thomas* P.E. & L.S.
 LIC. # 5009 CHIEF
 DATE APR 12 1977, SERIAL NO. 563

NEW JERSEY DEPARTMENT OF THE TREASURY
 DIVISION OF TAXATION
 APPROVED AS A TAX MAP PURSUANT TO THE
 PROVISIONS OF CHAPTER 175 LAWS OF 1913
 BY: *C. E. Bance* STATE SUPERVISOR
 DATE APR 22 1959, SERIAL NO. 239

REVISED: 19844 (?)
 LEONARD H. GREENFIELD & ASSOCIATES
 Professional Land Surveyor & Planner
 236 Myrtle Avenue
 Boonton, N.J. 07005

MONTVILLE TWP. TAX MAP
 MORRIS COUNTY NEW JERSEY
 SCALE 1" = 200' APRIL 1959
 AERO SERVICE CORPORATION
 210 E. COURTLAND STREET PHILADELPHIA, PA.

REV. 1963, 1967, 1970, 1973, 1977, 1987, 1982
 Stephen A. Jarombek
 Licensed
 Professional Planner & Land Surveyor
 Montville, N.J. 07045